

LEFFEL BUILDING

1715 SW Chandler Avenue | Bend, Oregon



Originally constructed for a single owner, this premium small clinical medical center is located just two blocks from Oregon State University on Chandler Avenue. The building has two separate dedicated parking lots with a total of 22 parking stalls not including on-street parking.

Suite 150 has HVAC to the suite, exterior walls, flooring, and utilities to the suite. Ready to be demised for a smaller westside healthcare professionally, this location provides a beautiful option to grow a business.

Contact listing broker for a private confidential tour.

Lease Rate:
\$1.25/SF/Mo + NNN

- Suite 150: 1,450 +/- SF gray shell (\$1.25/SF/Mo)
- Great west side location
- Est. NNN: \$0.52/SF/Mo

Brian Fratzke, CCIM, Principal

brian@fratcommercial.com | O 541-306-4948 C 541-480-2526

Tom Tapia, CCIM, Principal

tom@fratcommercial.com | O 541-306-4948 C 541-390-2900



963 SW Simpson Ave Suite 220 | Bend, OR 97702

541-306-4948 | www.fratzkecommercial.com

FOR LEASE
WEST SIDE MEDICAL SUITES

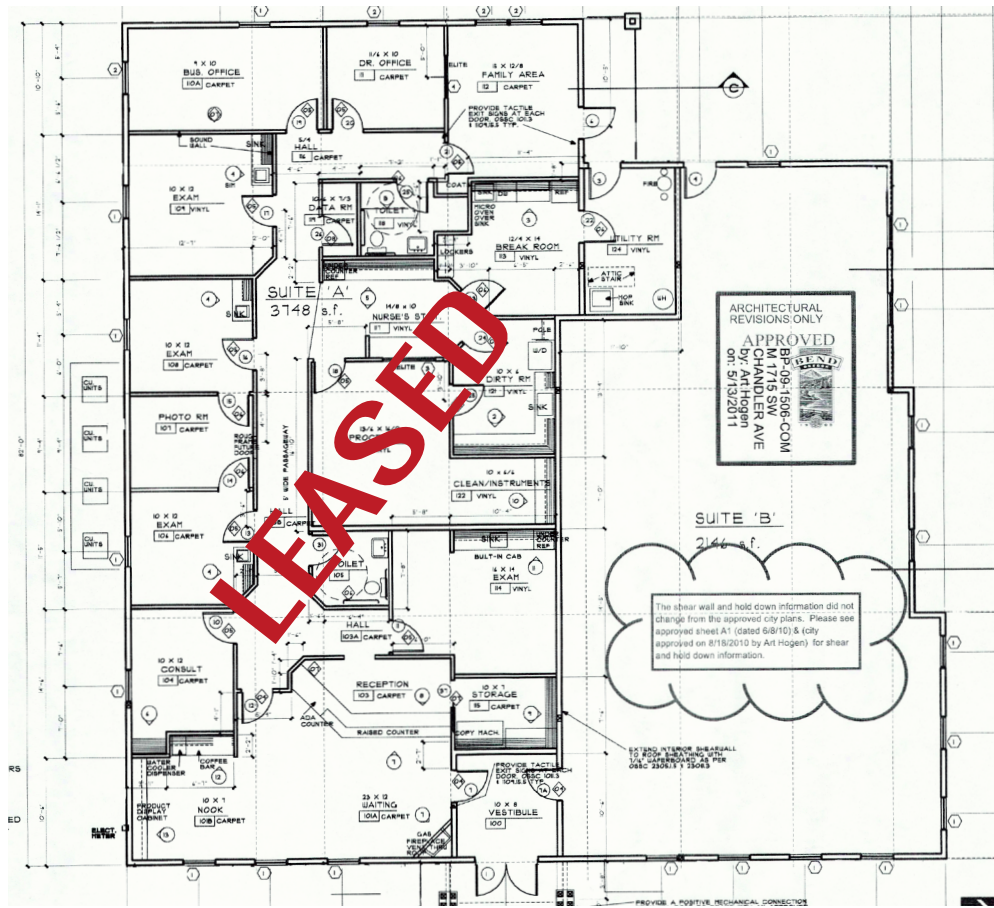

BRIAN FRATZKE
 CCIM, PRINCIPAL
 541-480-2526 [C]
 BRIAN@FRATCOMMERCIAL.COM



TOM TAPIA
 CCIM, PRINCIPAL
 541.390.2900 [C]
 TOM@FRATCOMMERCIAL.COM



With You Every Square Foot of the Way.

DISCLAIMER: This information is from sources we deem reliable, but for which we assume no liability. This is an exclusive listing. The information contained herein is given in confidence with the understanding that all negotiations pertaining to this property be handled through Fratzke Commercial Real Estate. All measurements are approximate.